

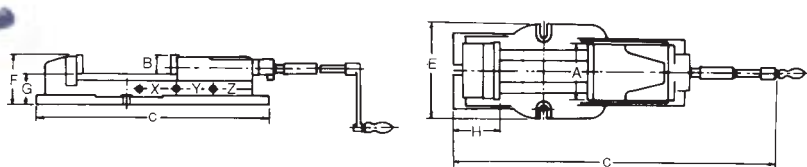

Hydraulic Machine Vise

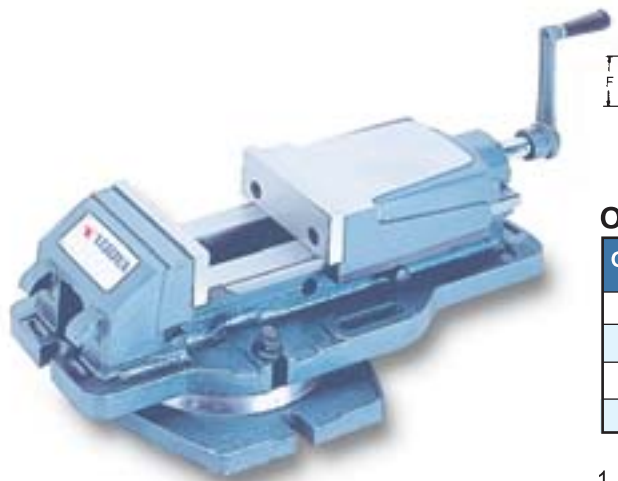

Order No. & Dimensions

Unit:mm

ORDER NO.	A	B	C	D	E	F	G	H	Max. Clamp Force	G.W.(kg)	Meas CFT	CODE NO.
VH-4	100	36	525	430	160	94	60	100	2500kgs	(C)28	0.8	1002-001
VH-5	127	46	670	540	185	118	72	117	4500kgs	(C)47	1.5	1002-002
VH-6	150	51	800	620	240	133	82	125	4500kgs	(C)65	2.2	1002-003
VH-8	200	65	800	710	280	158	100	180	6500kgs	(W)110	3.6	1002-004

1. Ruggedly constructed for milling, drilling, shaping, grinding and many other machine shop applications.
2. Body is made of high quality ductile cast iron, resists deflection or bending.
3. Sliding bed ways flame hardened and ground.
4. Concealed spindle for protection against chips and dirt.
5. Hydra-booster system for maximum clamping pressure with minimum force.
6. Quick of clamping & locking and easy of operation.
7. Accuracy within 0.02mm.
8. Furnished with or without swivel base.
9. Hydra-booster system is guaranteed for using 2 years limited.
10. The hydraulic oil number is 68#.

CLAMPING CAPACITY (3 STEPS CLAMPING POSITION FIG)

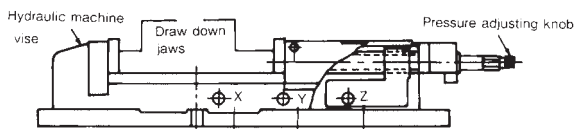

CLAMPING CAPACITY Unit:mm

ORDER NO.	X	Y	Z
VH-4, VHT-4	0-60	57-115	110-170
VH-5	0-80	78-115	140-208
VH-6, VHT-6	0-100	98-200	195-300
VH-8	0-100	98-200	195-300

Swivel base

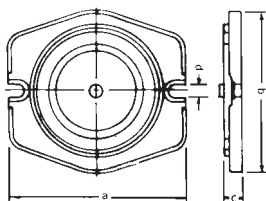

Unit:mm

ORDER NO.	a	b	c	d	G.W. (kg)	CODE NO.
HS-4	280	210	28	16	4	1002-010
HS-5	297	267	33	16	7	1002-011
HS-6	335	310	36	19	10	1002-012
HS-8	373	355	41	19	16	1002-013



Tilting Hydraulic Machine Vise

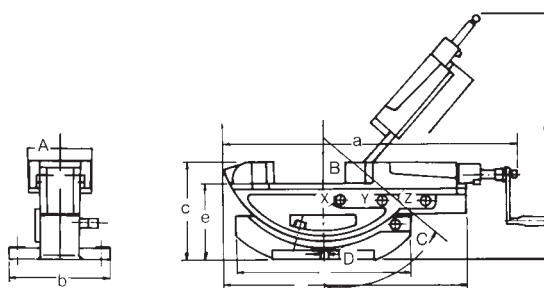

Unit:mm

ORDER NO.	A	B	C	D	a	b	c	d	e	Max. Clamp Force	G.W.(kg)	Meas CFT	CODE NO.
VHT-4	104	36	50°	14	523	162	177	MAX. 450	141	2500kgs	(W)33	1.2	1002-020
VHT-6	154	51	50°	14	801	242	237	MAX. 580	186	4400kgs	(W)81	4.4	1002-021

1. The same as characters of VH type. Swivel base same as VH type.
2. Tilting seat set by two locking screws, works in high stability.
3. Angle setting ranges from 0°~50°. Tilting degrees graduated for easy reading. Swivel base graduated to 360° and fixable in any position.
4. THE (3 STEPS CLAMPING POSITION) SAME AS VH TYPE.
5. Accuracy within 0.02mm
6. Hydra-booster system is guaranteed for using 2 years limited.